

WORK  MONITOR ARMS



+971 50 671 2599

sales03@workplace.ae | sales04@workplace.ae

# STRELA

## FLAT SCREEN MONITOR ARM

ABL's Strela combines value and versatility into a single product solution. The aluminium arm creates a stylish and elegant look adding to any home or office décor. The flexible arm joint and rotating/tilting VESA plate allows the user to adjust the height and angle of monitors, offering the optimum viewing experience. Strela is ideal for virtually any application due to its' ability to easily rotate between portrait and landscape orientation.

### PRODUCT SPECIFICATION



- 360° Rotary VESA Plate: for better viewing experience
- Free-Tilting Design: for multiple monitor viewing angles
- Built-in Cable Management: for an organised and neat workspace
- Aluminium Construction: provides a sleek, lighter, and elegant look
- Quick-Release VESA Plate: for easy installation
- Keyhole Pattern: allows easy installation
- Swiveling Arm(s): offer(s) maximum viewing flexibility

### AVAILABLE OPTIONS

### AVAILABLE COLOURS

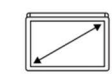
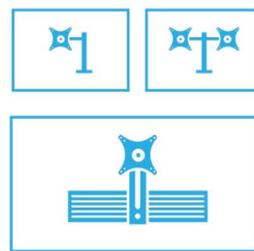

17"-32" (24")



75x75 & 100x100



+180°~-180°



+30°~-30°



+90°~-90°



8kg



Yes



Yes



Clamp

+971 50 671 2599

sales03@workplace.ae | sales04@workplace.ae

# INSTALLATION AND DIMENSIONS

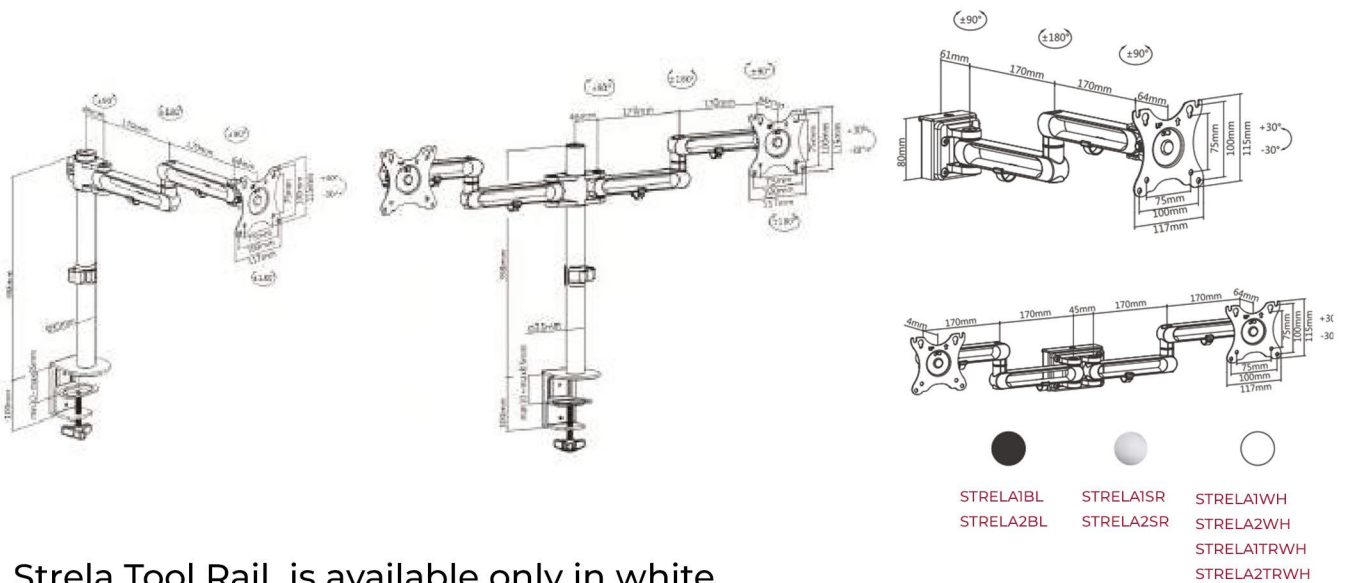

Strela Tool Rail is available only in white.

+971 50 671 2599

sales03@workplace.ae | sales04@workplace.ae

# FSA

## FLAT SCREEN MONITOR ARM

The well being of employees in the office space is becoming more vital, and the number one cause of lower neck pain is due to incorrect monitor positions. ABL are proud to offer a range of monitor arms designed to easily move and position the screen to the correct eye level. View our full range of FSA flat screen monitor arms.

### PRODUCT SPECIFICATION



- Three Mounting Options: Clamp Fitting - Top fix and Under desk and Grommet Fitting
- WEEE NO: WEE/JD006TX
- Cable Management clips
- Available in up to six arms and Tool Rail
- Load capacity 20kg for single/13kg per arm for double and 8kg per arm for three more arms.

### AVAILABLE OPTIONS

### AVAILABLE COLOURS

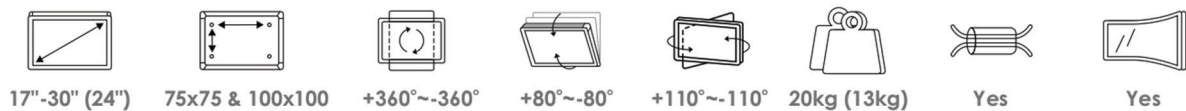
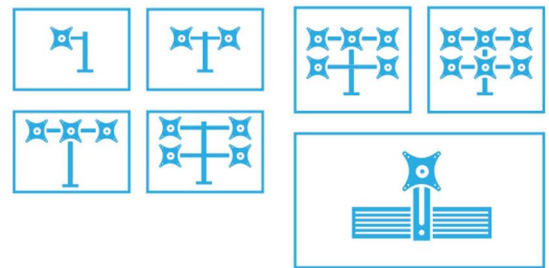

+971 50 671 2599

sales03@workplace.ae | sales04@workplace.ae



# INSTALLATION AND DIMENSIONS

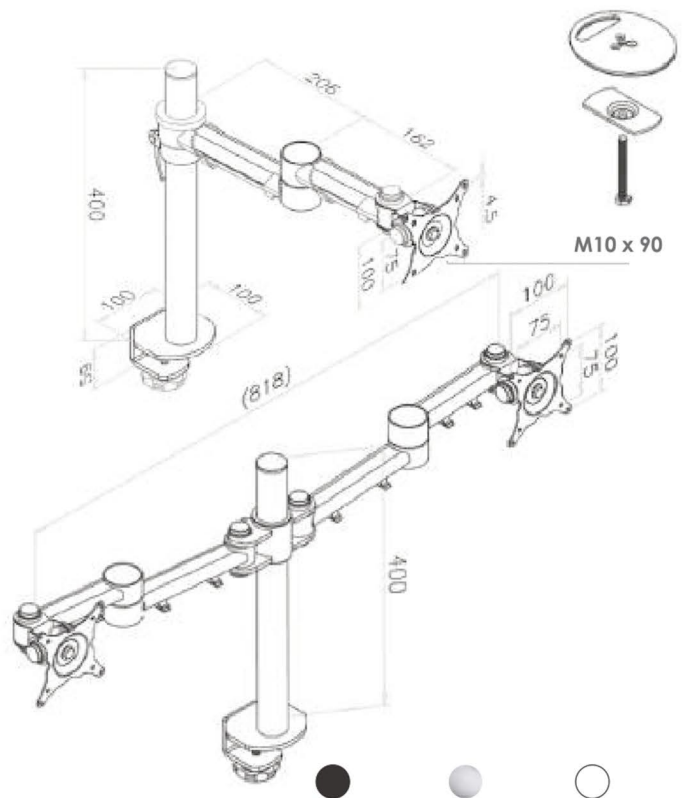
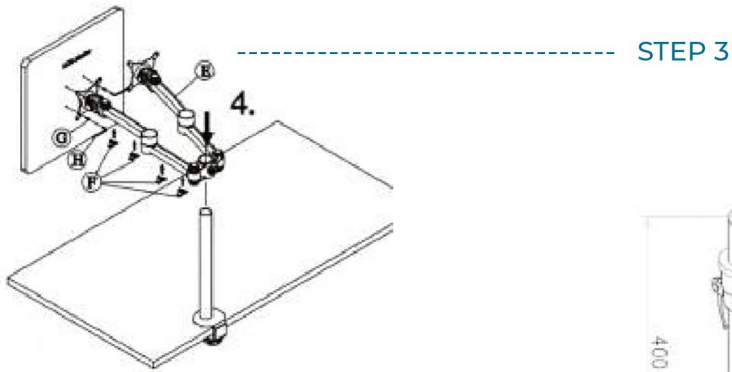
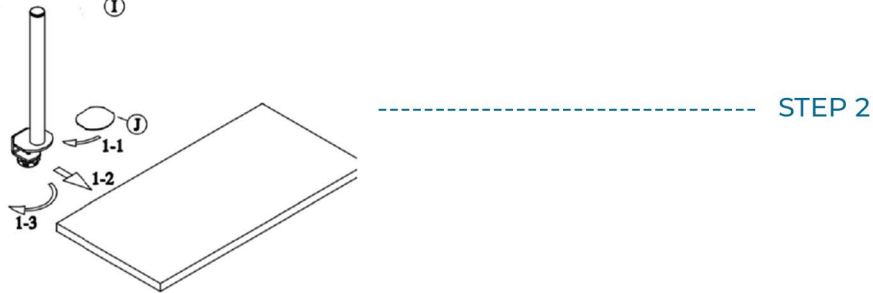
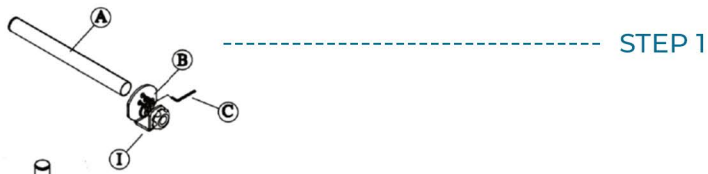

- STRELAIBL  
STRELA2BL
- STRELAISR  
STRELA2SR
- STRELA1WH  
STRELA2WH  
STRELA1TRWH  
STRELA2TRWH

+971 50 671 2599

sales03@workplace.ae | sales04@workplace.ae

# INSTALLATION AND DIMENSIONS

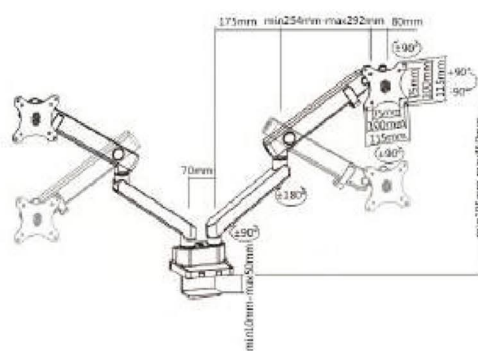
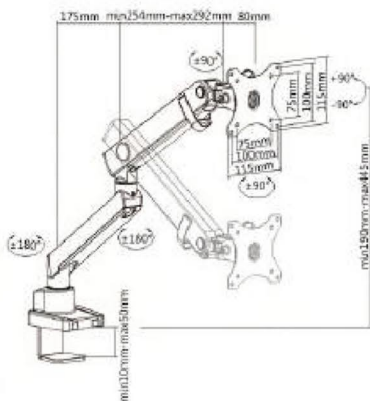

- STRELA1BL
- STRELA1SR
- STRELA2BL
- STRELA2SR

+971 50 671 2599

sales03@workplace.ae | sales04@workplace.ae

# SIGMA

## SPRING ASSISTED MONITOR ARM

ABL's flat screen monitor arm Sigma is a quick to assemble and easy to use monitor arm facilitating the needs of single or double monitors. The effortless design allows the installer to fit the arm in minutes and the rotation/swivel features make it easy to meet the needs of the end user, as they can place the screen at the correct height to avoid neck and back tension

### PRODUCT SPECIFICATION



- Top fix installation and through desk bolt fitting included
- Smooth Arm Insertion: ensure easy installation
- Built-in Spring Tension Gauge: for perfect weight adjustments
- Spring-Assisted Mechanism: allows to easily move up and down
- Quick-Release VESA plate: for easy installation
- Cable management/Allen Key holder

### AVAILABLE OPTIONS

### AVAILABLE COLOURS



17"-32"



75x75 & 100x100



+90°~-90°



+90°~-90°



+90°~-90°



8kg



Yes



Yes

+971 50 671 2599

sales03@workplace.ae | sales04@workplace.ae

# SINGLE HYDRAULIC MONITOR ARMS

## FEATURES:

- Easy to adjust the monitor angle and position to satisfy the different view
- Constant force function design, use the gas cylinder structure to help easy adjustment for comfortable viewing
- Both monitor and laptop could be adjusted separately without interference for the original dual-gas cylinder design



## SINGLE HYDRAULIC MONITOR ARMS

- Color: Silver, Black, White
- Model: HS-100-S
- Material: Aluminium
- Capacity: 2-10 kg , 8-20 kg

+971 50 671 2599

sales03@workplace.ae | sales04@workplace.ae



# TECHNICAL SPECIFICATION

- Name: Single hydraulic Monitor arms
- Color: Silver
- Material: Aluminium
- Model: HS-100-S

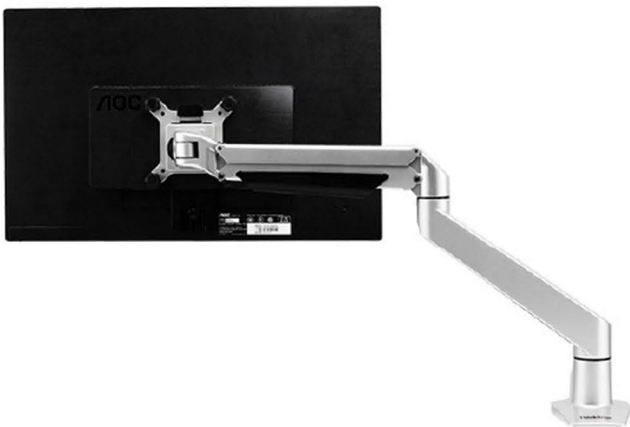

+971 50 671 2599

sales03@workplace.ae | sales04@workplace.ae

# INSTALLATION GUIDE

## LCD Monitor Arm // Installation Manual

Product name: **GTEK Single Monitor Arm**

### Product Specification

Sketch											Desk thickness(mm)	
Item	Monitor size	Weight range (kg)	Lift(mm)	Tilt	Swivel	Pivot	VESA	Packing size (mm)	N.W(kg)	G.W(kg)	Thru-desk	Desk clamp
Specification	≤30"	2-10	340	+75°~ -30°	±90°	±90°	75*75	Inner: 475*195*140	Inner: 3.3	Inner: 3.8	50	50
		8-20						Outer: 490*210*440				
							100*100	Inner/Outside: 3/1				

### Product Size

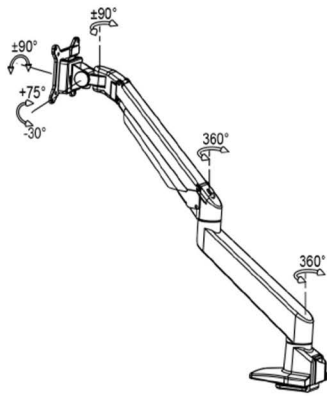
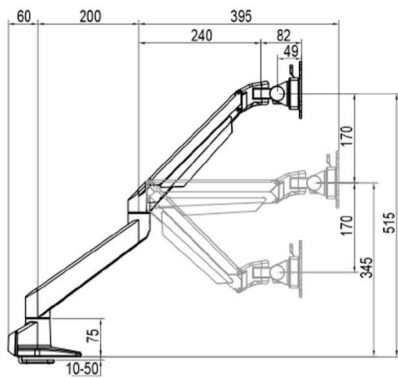

### Installation – Desk Clamp

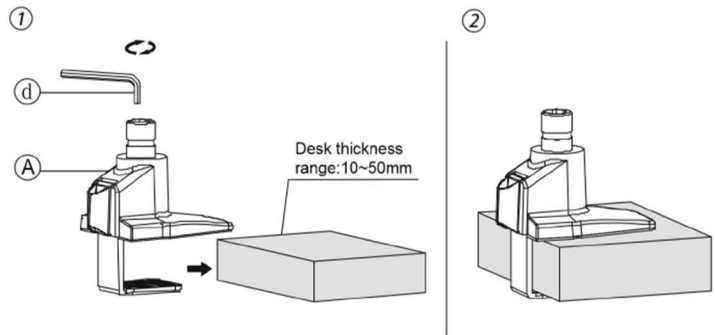

### Installation – Thru-desk

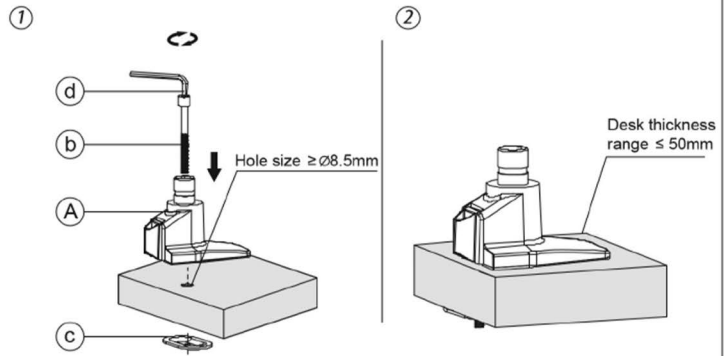

### Install Procedure

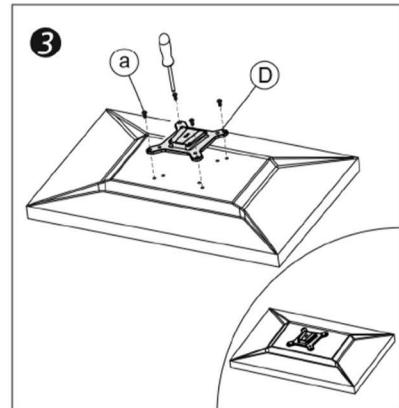
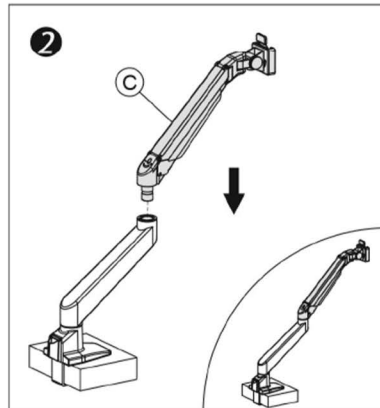
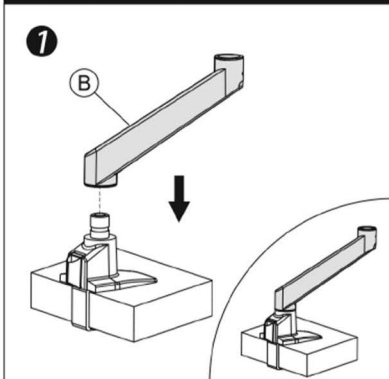

+971 50 671 2599

sales03@workplace.ae | sales04@workplace.ae

# DIMENSION SHEET

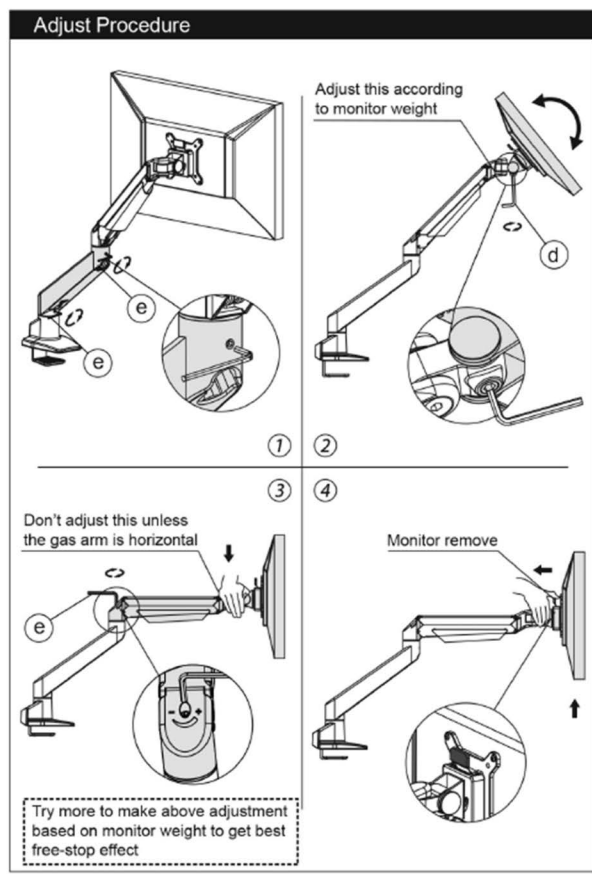
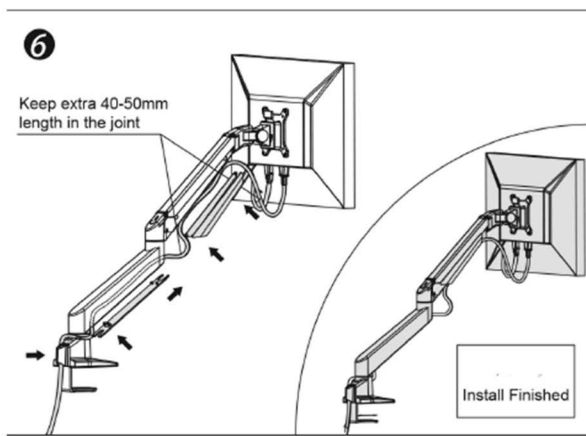
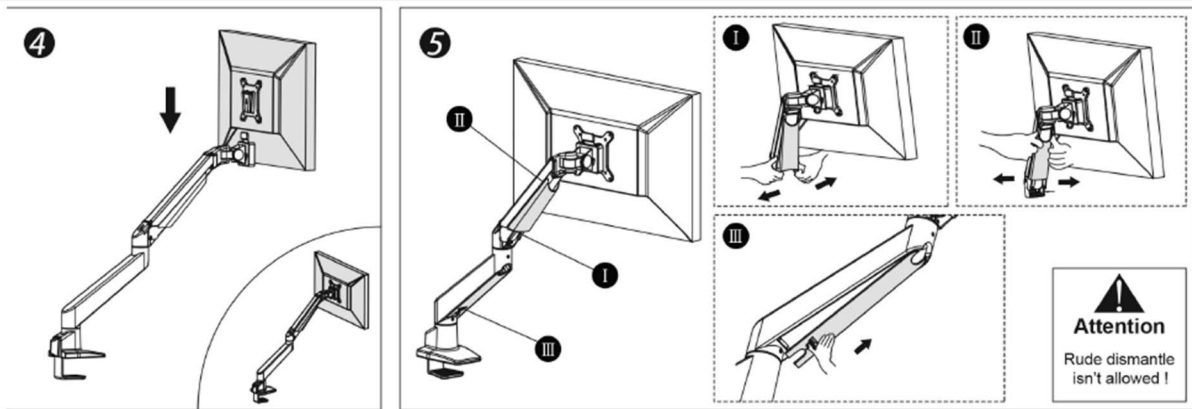

Module List			
No.	Sketch	Specs	Quantity
A			1
B			1
C			1
D			1

Part List			
No.	Sketch	Specs	Quantity
a		M4x12	4
b		M8x160	1
c			1
d		M6	1
e		M4	1

+971 50 671 2599

sales03@workplace.ae | sales04@workplace.ae

# PIPE-SHAPED COUNTERBALANCE SPRING-ASSISTED MONITOR ARMS



**DETACHABLE VESA PLATE**  
for quick attachment and detachment



**INTEGRATED CABLE MANAGEMENT**  
keeps desktop free of cords and clutter



**QUICK-RELEASE JOINT**  
or easy assembly and makes best use of  
packaging (perfect for e-commerce)

+971 50 671 2599

sales03@workplace.ae | sales04@workplace.ae





**LDT71-C012**

Clamp Only

**LDT71-C024**

Clamp Only

**LDT71-C012N**

Clamp and Grommet

**LDT71-C024N**

Clamp and Grommet

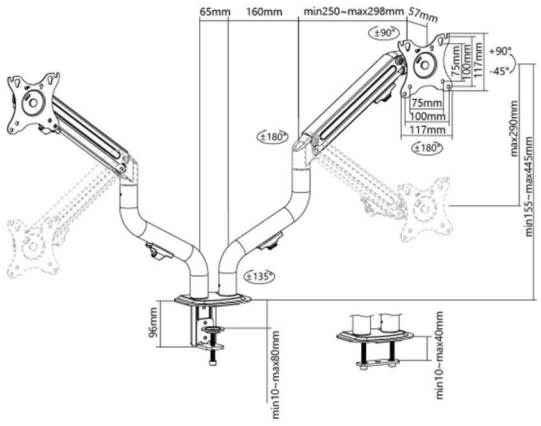
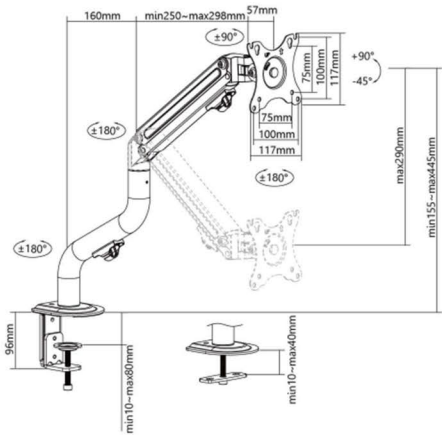

Item No	LDT71-C012/LDT71-C012N	LDT71-C024/LDT71-C024N
---------	------------------------	------------------------

Fit Screen Size	17"-32"	17"-32"
Weight Capacity (per screen)	2-8kg/4.4lbs-17.6lbs	2-8kg/4.4lbs-17.6lbs
VESA Compatible	75x75,100x100	75x75,100x100
Tilt Range	+90°- -45°	+90°- -45°
Swivel Range	+90°--90°	+90°--90°
Screen Rotation	+180°--180°	+180°--180°
Material	Steel, Aluminum,Plastic	Steel, Aluminum,Plastic

+971 50 671 2599

sales03@workplace.ae | sales04@workplace.ae

# DUAL LCD MOUNT



## DESCRIPTION

- 2 Dual section LCD arms.
- Adjustable height to raise your screen height and adapt your perspective.
- Tilt, rotate and swivel your arm and monitor to multiple comfortable position, effectively reducing the pain and strain on your neck and back.
- Deck clamp mount to the edge of your desk easily and firmly.

## SPECIFICATION

Application to	2LCD<32" with VESA hole
Vertical Angle	-55°~90°
VESA Compatible	75*75mm, 100*100mm
Max.load	1LCD<7kgs
Screen Rotation	360°
Desk Thickness	0.78"-2.36"
Height adjust range	3.40cm
Clamp Range	2.6cm
Matreial	Aluminum & ABS
Color	Silver/Black
Inner Box	45.5-34.12cm
Master Carton/Carton Ratio	47.35*35.7*48cm/4 pcs
G.W / CTN (KGS)	20.95

+971 50 671 2599

sales03@workplace.ae | sales04@workplace.ae

# DUAL LCD MOUNT



## DESCRIPTION

- 2 Dual section LCD arms.
- Adjustable height to raise your screen height and adapt your perspective.
- Tilt, rotate and swivel your arm and monitor to multiple comfortable position, effectively reducing the pain and strain on your neck and back.
- Desk clamp mount to the edge of your desk easily and firmly.

## SPECIFICATION

Application to	2LCD<32" with VESA hole
Vertical Angle	-55°~90°
VESA Compatible	75*75mm, 100*100mm
Max.load	1LCD<7kgs
Screen Rotation	360°
Desk Thickness	0.78"-2.36"
Height adjust range	3.40cm
Clamp Range	2.6cm
Matreial	Aluminum & ABS
Color	Silver/Black
Inner Box	45.5-34.12cm
Master Carton/Carton Ratio	47.35*35.7*48cm/4 pcs
G.W / CTN (KGS)	20.95

+971 50 671 2599

sales03@workplace.ae | sales04@workplace.ae

# GAS SPRING DUAL LCD MOUNT



## DESCRIPTION

- 2 gas spring arm with adjustment freely
- Adjustable height to raise your screen height and adapt your perspective.
- Tilt, rotate and swivel your arm and monitor to multiple comfortable position, effectively reducing the pain and strain on your neck and back.
- Desk clamp mount to the edge of your desk easily and firmly.

## SPECIFICATION

Application to	2LCD<32" with VESA hole
Vertical Angle	-55°~90°
VESA Compatible	75*75mm, 100*100mm
Max.load	1LCD<7kgs
Screen Rotation	360°
Desk Thickness	0.78"-2.36"
Matreial	Aluminum & ABS
Load	2-9kg
Color	Silver/Dark Grey
Inner Box	45*36*1212cm
Master Carton/Carton Ratio	74*46.5*26.5cm/4 pcs
G.W / CTN (KGS)	27.42

+971 50 671 2599

sales03@workplace.ae | sales04@workplace.ae



# GAS SPRING DUAL LCD MOUNT



## DESCRIPTION

- 2 gas spring arm with adjustment freely
- 1 Adjustable height platform-adjustable height to raise your screen height and adapt your perspective.
- Tilt, rotate and swivel your arm and monitor to multiple comfortable position, effectively reducing the pain and strain on your neck and back.
- Desk clamp mount to the edge of your desk easily and firmly.

## SPECIFICATION

Application to	2LCD<32" with VESA hole
Max.load	1LCD<7kgs
Height adjust range	3-40cm
Clamp range	2-6cm
Matreial	Aluminum & ABS
Color	Silver/Dark Grey
Inner Box	45*36*12cm
Master Carton/Carton Ratio	74*46.5*26.5cm/4 pcs
G.W / CTN (KGS)	27.42

+971 50 671 2599

sales03@workplace.ae | sales04@workplace.ae

# COMPUTER MOUNT



## DESCRIPTION

- 2 Dual section arms
- Adjustable height to raise your screen height and adapt your perspective.
- Tilt, rotate and swivel your arm and monitor to multiple comfortable position, effectively reducing the pain and strain on your neck and back.
- Desk clamp mount to the edge of your desk easily and firmly.

## SPECIFICATION

Application to	Universal
Max.load	1LCD<7kgs
Height adjust range	3-40cm
Clamp range	2-6cm
Matreial	Aluminum & ABS
Color	Silver
Inner Box	45*36*12cm
Master Carton/Carton Ratio	74*46.5*26.5cm/4 pcs
G.W / CTN (KGS)	17

+971 50 671 2599

sales03@workplace.ae | sales04@workplace.ae

# SINGLE HYDRAULIC MONITOR ARMS



## SINGLE HYDRAULIC MONITOR ARMS

### FEATURES

- Easy to adjust the monitor angle and position to satisfy the different view
- Constant force function design, use the gas cylinder structure to help easy adjustment for comfortable viewing
- Both monitor and laptop could be adjusted separately without interference for the original dual-gas cylinder design

### MONITOR ARMS

## Single hydraulic Monitor arms

Color: Silver, Black, White

Model: HS-100-S

Material: Aluminium

Capacity: 2-10 kg 8-20 kg

+971 50 671 2599

sales03@workplace.ae | sales04@workplace.ae

## TECHNICAL SPECIFICATION

**Name :** Single Hydraulic Monitor Arm

**Color :** Silver

**Material :** Aluminum

**Model :** HS - 100 - S



+971 50 671 2599

sales03@workplace.ae | sales04@workplace.ae



# COUNTERBALANCE MONITOR ARMS

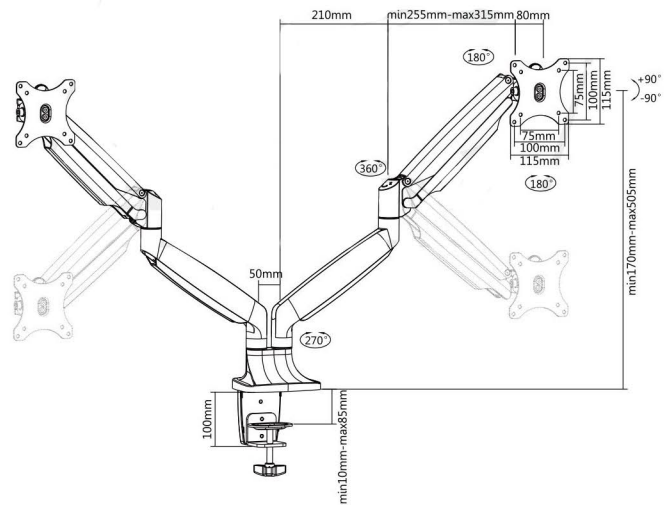
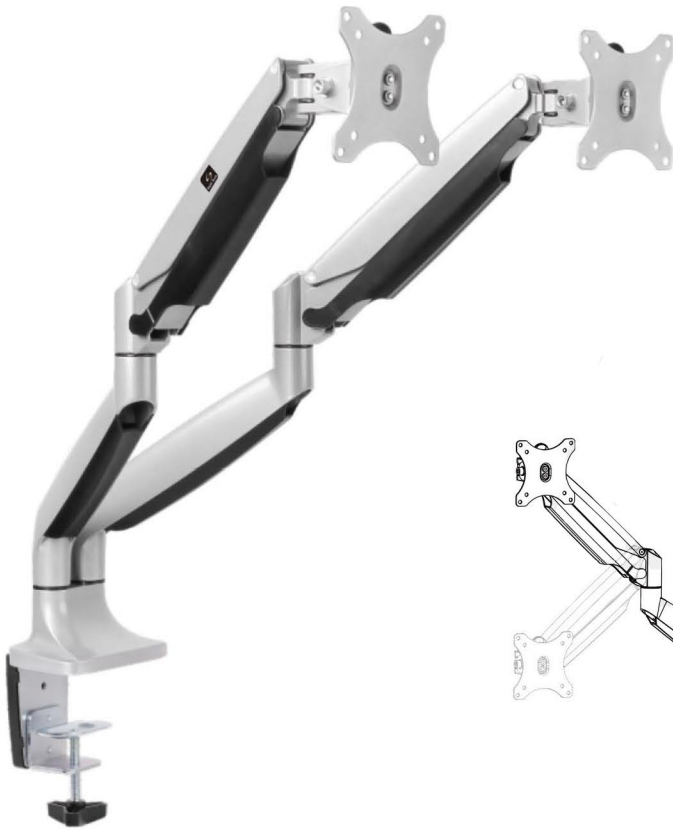

## COUNTERBALANCE MONITOR ARMS



### MONITOR ARMS

## Counterbalance Monitor arms

Color: Silver, Black, White

Model: SH-100-C024

Material: Aluminium

Capacity: 1.9kg/2.2-19.8lbs(x2)

+971 50 671 2599

sales03@workplace.ae | sales04@workplace.ae

## TECHNICAL SPECIFICATION

Name : Counderbalance Monior Arm

Color : Sliver

Material : Aluminum

Model : SH-100-C024

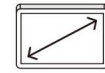

Screen Size  
13"-32"



Weight Capacity  
1-9kg/2.2-19.8lbs  
(x2)

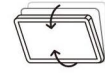

Tilt Range  
+90° ~ -90°

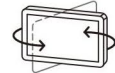

Swivel Range  
+90° ~ -90°

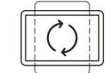

Screen Rotation  
180°

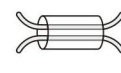

Cable  
Management

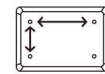

VESA Compatible  
75x75 100x100



Curved Monitor



+971 50 671 2599

sales03@workplace.ae | sales04@workplace.ae

# CABLE MANAGER FOR DESK



## TECHNICAL SPECIFICATION

- Name : Snake umbilical raiser
- Color : Black
- Height : 75cm
- Material : Polypropylene
- Model : U 100
- Capacity : Only wires

+971 50 671 2599

✉ info@workplace.ae | sales03@workplace.ae



## CONTACT US!

 +971 50 671 2599

 [www.workplace.ae](http://www.workplace.ae)

 [sales03@workplace.ae](mailto:sales03@workplace.ae) | [sales04@workplace.ae](mailto:sales04@workplace.ae)

 Workplace Furniture Trading llc, 113 - 34 Sai Business Center,  
Al Makhawi Building, Umm Hurair Street, Oud Metha,  
Dubai, UAE, Po Box 80744.